

Installation & Safety Instructions

Installation must be carried out by a qualified electrician in accordance with the applicable regulations.

The device has to be fitted in accordance with building regulations for electrical and fire safety.
This requires installation in a 1 Gang Box or larger electrical enclosure.

The device may only be operated on a fuse or circuit breaker with a rating of 120VAC / 15A.

The 3-Wire configuration is recommended, as it provides optimal dimming performance for connected lighting.

If no neutral wire (N) is available, the 2-Wire configuration can be used. Please note that this method may lead to limitations in dimming performance.

The device is free of maintenance and must only be cleaned with a dry cloth.
The device must not be used as part of safety-critical systems.

Connecting cables

Wire cross-section	1.5mm ² / AWG16
Stripping length	11mm / 0.43"
Temperature resistance	90°C / 194°F
Cable length	160mm / 6.3"

Lever connectors

Wire cross-section	1.5 ... 4mm ² / AWG16 ... 12
Stripping length	11mm / 0.43"
Temperature resistance	85°C / 185°F



For more information
about this product, visit
loxone.com/nano-dimmer-air-us

V180325

**Loxone
Electronics GmbH**
Smart Home 1
4154 Kollerschlag
Austria

Loxone US
3060 Plaza Drive
Suite 105
Garnet Valley, PA 19060
United States



For additional information,
declaration of conformity, visit
www.loxone.com/datasheets



Need Help?
loxone.com/support



LOXONE

Nano Dimmer Air US

Part No.: 100499

About the product

The Nano Dimmer Air US integrates LED lamps, incandescent bulbs and more into the Loxone ecosystem. Thereby they can become part of lighting moods, alarm lights, all-off-scenes and much more. An optional plug-on module enables a variety of further control options in the Loxone system.

Features:

- Freely programmable dimmable output
- Expandable with controls via plug-in connector

Technical Data

Mains voltage	120VAC +-10% / 60Hz
Power consumption	typ. 0.5W
Power loss	max. 2W
Dimmable Output (trailing- or leading-edge)	2-Wire min. load: 25W 3-Wire min. load: None Incandescent/Halogen load: max. 400W LED load: max. 200W Leading-edge dimming is only supported in a 3-Wire configuration.
Loxone Air Frequencies & Channels	915MHz (ISM Band Region 2), 10 channels, max. 13.2mW internal antenna
Ambient Temperature	-20 ... 40°C / -4 ... 104°F
Ambient Humidity	max. 90% r.H. (non condensing)
Ingress Protection	IP20

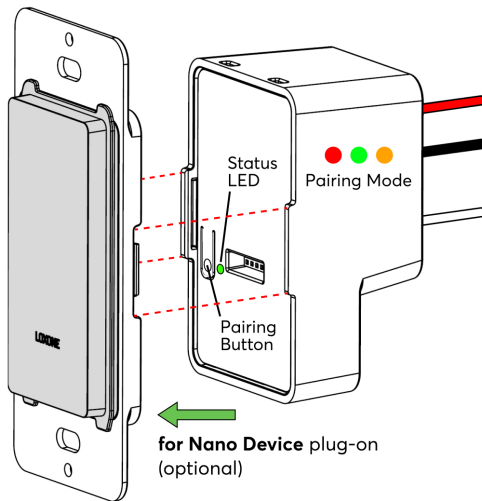

Contains **FCC ID: 2ARRV-000375** This device complies with part 15 of the FCC Rules. Operation is subject to the following two conditions:

1. This device may not cause harmful interference.
2. This device must accept any interference received, including interference that may cause undesired operation.

2-Wire Configuration

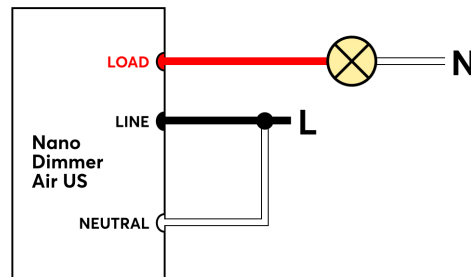

3-Wire Configuration

