

Datasheet

Loxone Touch Adapter Plate (1-Gang)

4.7 x 4.7 in / 119.4 x 119.4 mm

by Shocker Automation

Item No. – White: 500055

Item No. – Anthracite: 500060

About the product:

The Loxone Touch Adapter Plate* is a staple to lighting system conversions so you can easily replace a standard light switch with a Loxone Touch switch. Available in white or anthracite, it enables seamless integration of a Loxone system.

- Dimensions: 4.7 x 4.7 in / 119.4 x 119.4 mm
- Powder coated finish in white or anthracite
- Countersunk for standard switch plate screw
- Ideal for centralized lighting conversions (i.e. LiteTouch, etc.)
- 1/8" aluminum construction

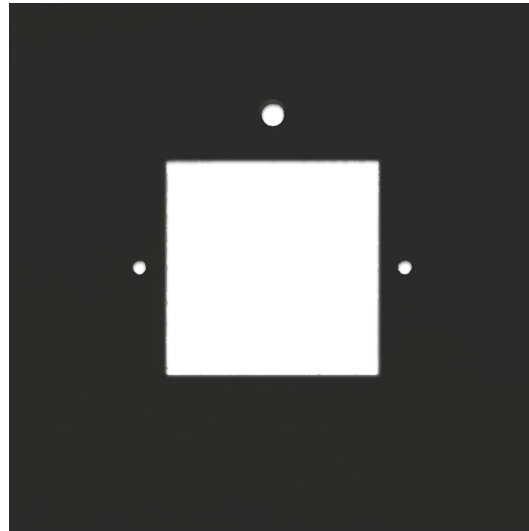

*This is a third-party product and we can not offer additional dealer discounts.

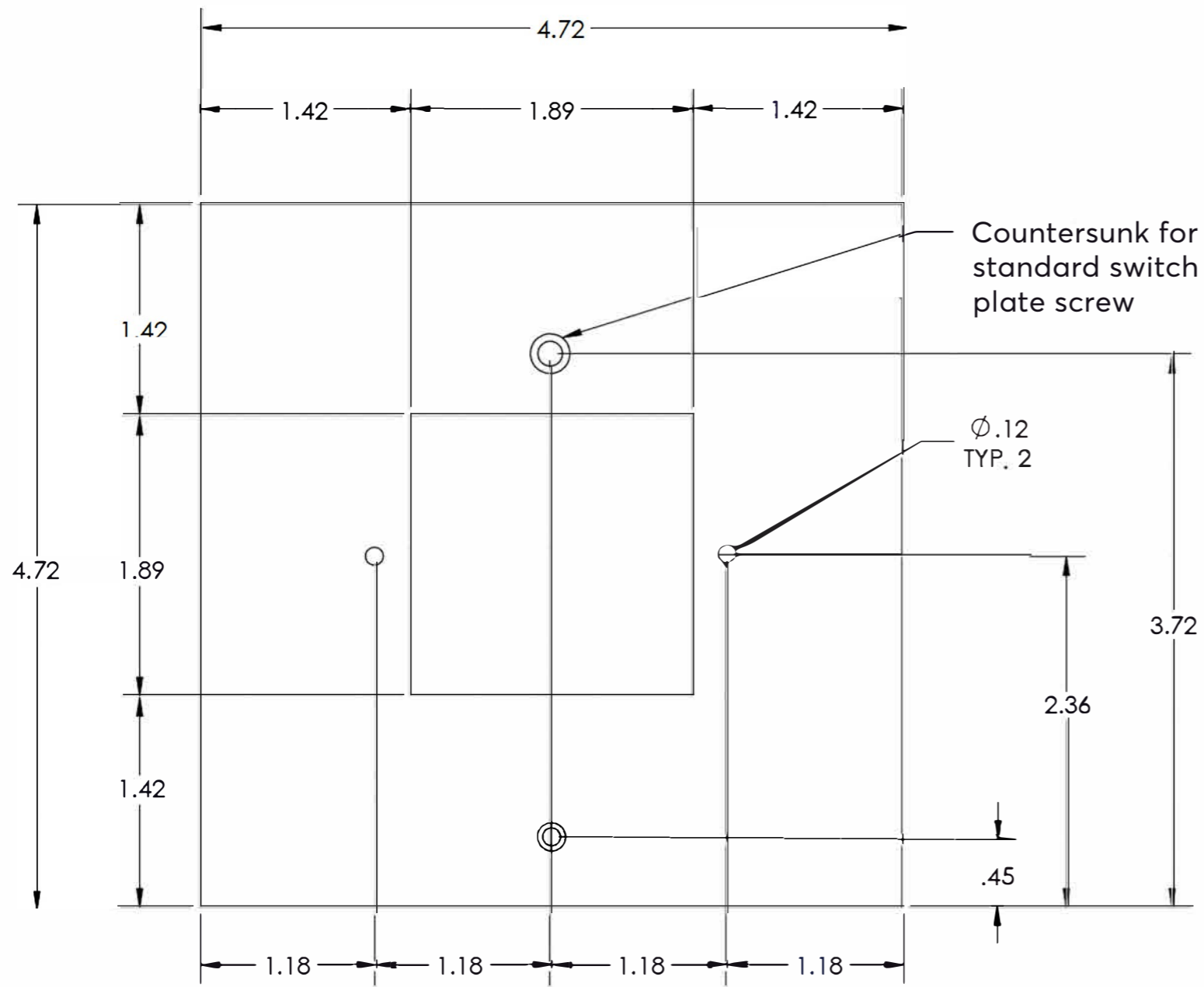

Front view

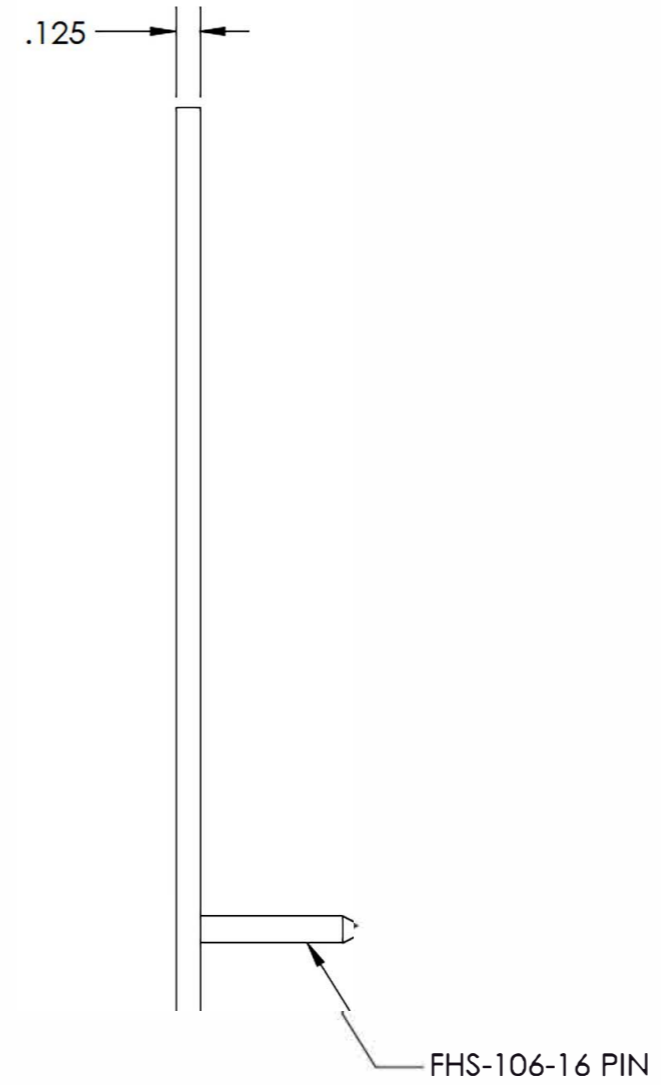

Side view

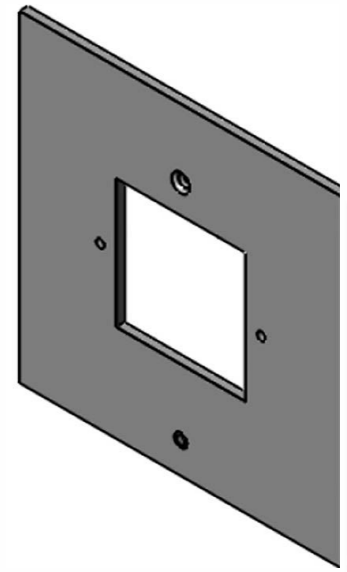

Isometric front view

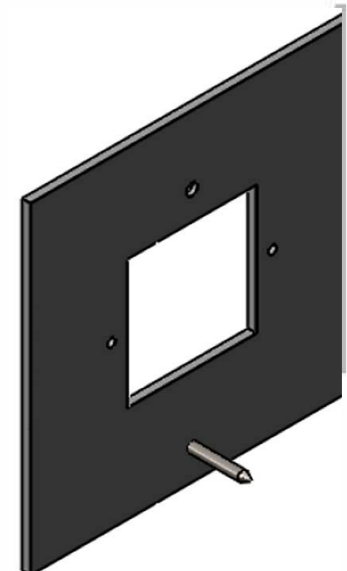

Isometric rear view